

Bottom floor drain DN50/82 stainless steel



stainless steel grid 1.5 mm



Part number	Packaging [pcs/pallet]	Flow rate [l/min]	Weight [kg/pc]
320 XN	10/480	32	0,38

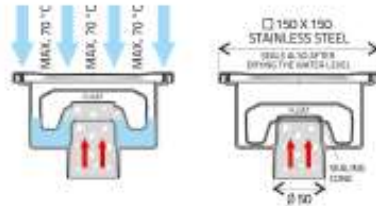
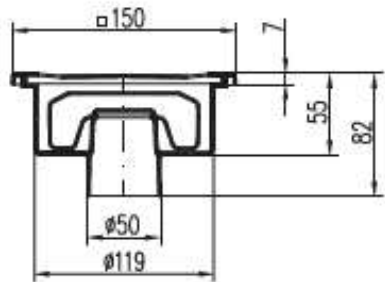

BOTTOM OUTLET DN50

SIDE OUTLET DN50 and stainless steel frame

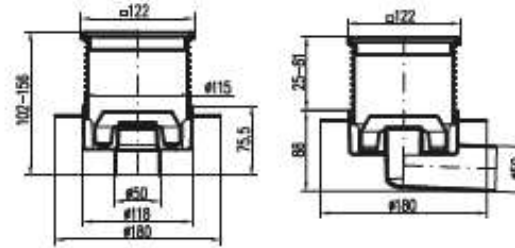

420 XL
425 XL

420 NXL
425 NXL

Floor drain with bottom / side outlet, DN50, with a plastic / stainless steel frame

The floor drain with a bottom/side outlet and a float is intended for indoor use. It is made with a full stainless steel finish. When the floor level sinks, the NEPTUNE float will block the drain, thus preventing the backflow of stench from the sewer pipe. Made from polypropylene, ABS and stainless steel DIN 1.4301. Load K3 (300 kg), heat resistance up to 70 °C, standard EN 1253.

Part number	Finish	Packaging [pcs/pallet]	Flow rate [l/min]	Weight [kg/pc]	Outlet
420 XL		8/192	29-48	0,53	bottom
425 XL		8/192	43-58	0,56	side
420 NXL		8/192	29-48	0,56	bottom
425 NXL		8/192	43-58	0,59	side

Part number	Finish	Packaging [pcs/pallet]	Flow rate [l/min]	Weight [kg/pc]	Outlet
430 XL	full stainless steel	8/192	27-46	0,56	bottom
435 XL	full stainless steel	8/192	41-56	0,59	side

Part number	Finish	Packaging [pcs/pallet]	Flow rate [l/min]	Weight [kg/pc]	Outlet
440 XL		8/192	27-46	0,63	bottom
445 XL		8/192	41-56	0,66	side

Part number	Finish	Packaging [pcs/pallet]	Flow rate [l/min]	Weight [kg/pc]	Outlet
F 420 XL		8/160	29-48	0,85	bottom
F 425 XL		8/160	43-58	0,88	side
F 420 NXL		8/160	29-48	0,88	bottom
F 425 NXL		8/160	43-58	0,91	side

Part number	Finish	Packaging [pcs/pallet]	Flow rate [l/min]	Weight [kg/pc]	Outlet
L 420 XL		8/160	29-48	0,85	bottom
L 425 XL		8/160	43-58	0,88	side
L 420 NXL		8/160	29-48	0,88	bottom
L 425 NXL		8/160	43-58	0,91	side

Part number	Finish	Packaging [pcs/pallet]	Flow rate [l/min]	Weight [kg/pc]	Outlet
G 420 XL		8/160	29-48	0,85	bottom
G 425 XL		8/160	43-58	0,88	side
G 420 NXL		8/160	29-48	0,88	bottom
G 425 NXL		8/160	43-58	0,91	side

Side floor drain DN50/95 stainless steel



stainless steel grid 1.5 mm



Part number	Packaging [pcs/pallet]	Flow rate [l/min]	Weight [kg/pc]
326 XN	12/576	38	0,43

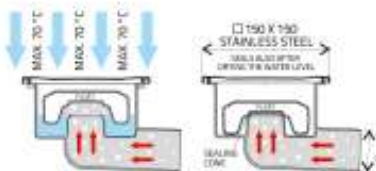
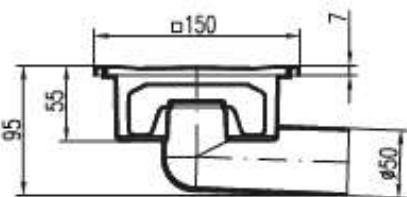

440 XL
445 XL

F 420 XL
F 425 XL

F 420 NXL
F 425 NXL

L 420 XL
L 425 XL

L 420 NXL
L 425 NXL

G 420 XL
G 425 XL

G 420 NXL
G 425 NXL